

BIN COMPACTOR ATTACHMENT MFC110 SPECIFICATIONS

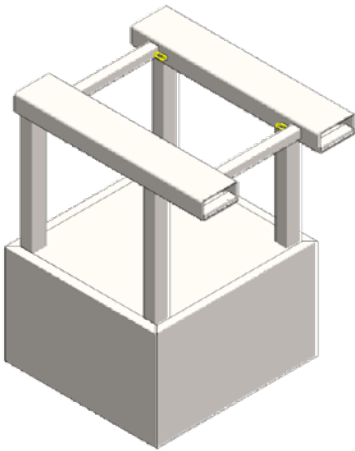

MFC110 Bin Compactor is designed to safely and effortlessly compact bulky waste products such as cardboard and plastic with approx. 1T weight.

Features:

- Used to compact bulky waste products
- Suitable for use with 1100L wheelie bin
- Eliminates the unsafe practice of treading down loose waste
- Slip-on attachment and safety chain for quick connection to a forklift
- Increased bin capacity helps lower waste removal costs
- Also available is model MFC66 to suit 660L bins
- Enamel paint finish



Load Centre	660mm
Counterweight Dimensions	900(w) x 850(d) mm
Height	1300mm
Unit Weight	1060kg
HCG	610mm
Fork Pocket Size	185 x 65mm
Fork Pocket Centres	650mm

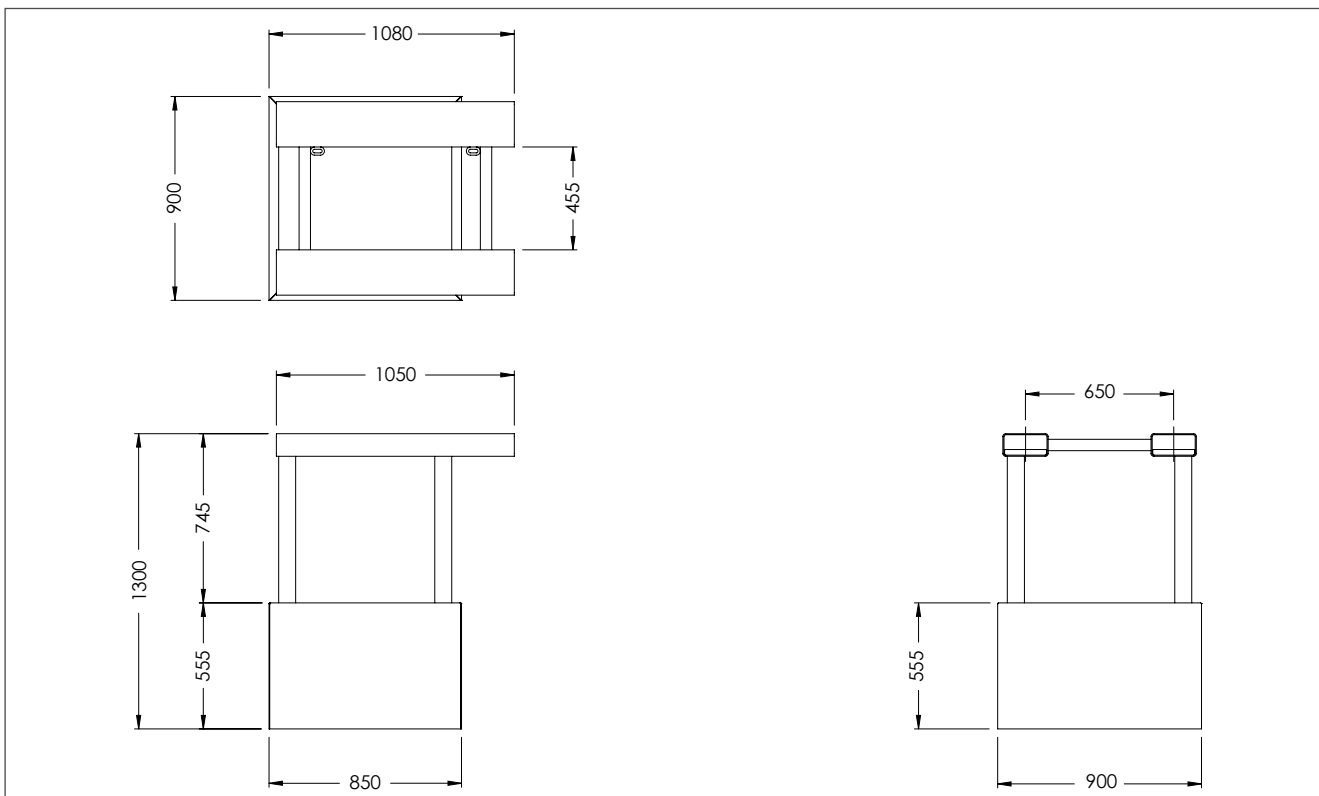

Australia Wide Sales & Service

sales@materialshandling.com.au | www.materialshandling.com.au | 1300 65 00 35

MATERIALS
Handling PTV LTD Working with ease™