

NEO 30™

Innovation beyond gravity

Revolutionary smart-lifting device

That supports your business and employees



The complete package includes:

- NEO 30 • Swivel • Adapter • Charger
- Two batteries • Hook • Product manual



Smart-lifting for everyone!

- Fast and easy to install
- Battery-driven
- Mobile, easy to move around and can operate on different working stations
- A wide range of standard end effectors
- Lifts goods up to 30 kg with minimum effort
- Safe and precise, provides users with ergonomic lifting



Start using your NEO 30 in three easy steps:



Technical data:

Height – 410 mm | Width – 132 mm | Depth – 121 mm | Weight – 7.5 kg
Max lifting capacity – 30 kg
Max stroke – 1.4 m
Max speed – 0.50-0.25 m/s, depending on load
Lifting strokes on one charge – 500–200 depending on load and stroke

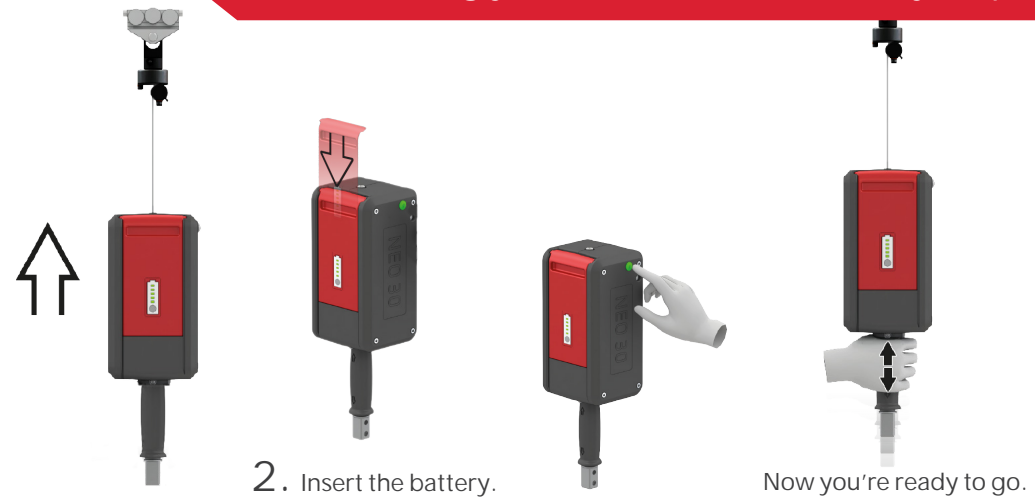

1. Hang it on any attachment.

2. Insert the battery.

3. Push the green button.

Now you're ready to go.