



## Standard Height Bars

Eliminate damage to vehicles and property caused by oversize vehicles entering areas of restricted height by installing suspended Height Bars.

Our Height Bars are available in five standard lengths: 2, 3, 4, 5 or 6 metres and come with suspension chain and hanger assemblies. Powder coated safety yellow with reflective diagonal stripes, they carry the text "LOW CLEARANCE" with the specified height in black letters on a white background.

Use height bars at locations where vehicles first enter an undercover area or encounter an overhead obstruction where the clearance in either case is: (i) 3 metres or less if only cars or light vans are likely to use the facility or (ii) 4.6 metres or less in all other areas.

### Product Features:

- Eliminate damage to vehicles and property caused by over height vehicles.
- New aluminium design has 50% larger face for improved visibility.
- Hanger assemblies now fully adjustable at stand-off brackets and height bar for simplified installation.
- Available in five standard lengths or custom made to any length\*.
- Height bars are supplied with new adjustable hanger assemblies and chain.
- Powder coated Yellow with reflective face.
- Displays "LOW CLEARANCE" text and the required clearance (specified when ordering).
- Optional adjustable offset brackets available.
- Freestanding surface mount or below ground posts are available for installation where there is no existing supporting structure.

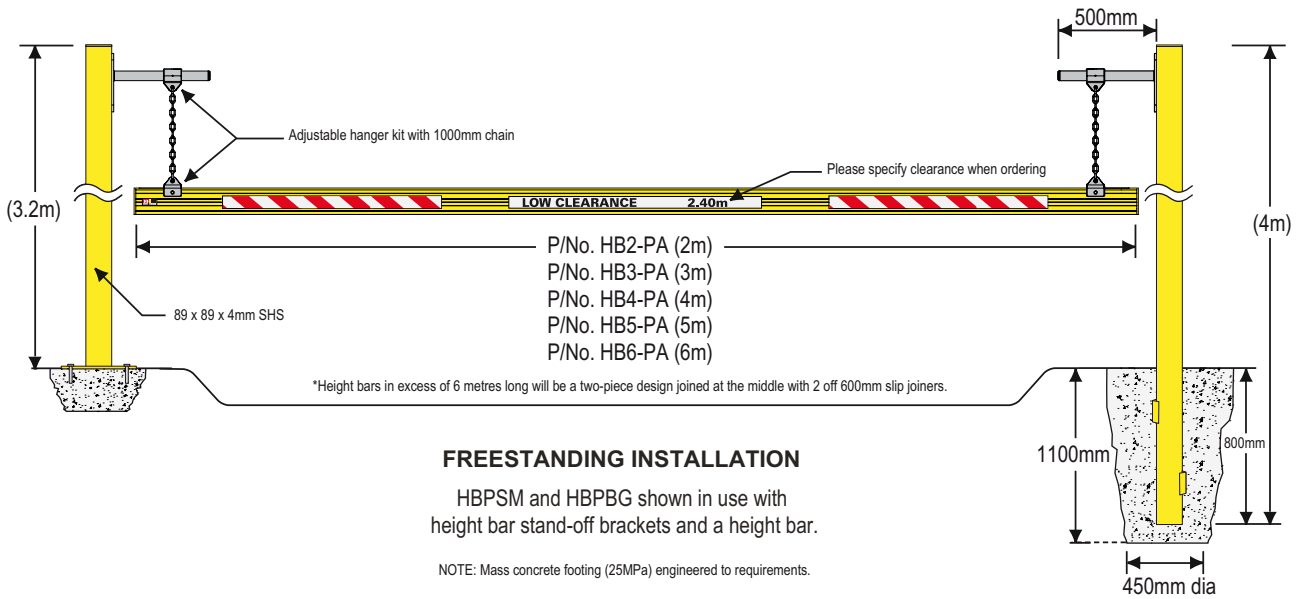

Part No.	Product Description
<b>HB2-PA</b>	2 metre aluminium height bar with text and hanger kit
<b>HB3-PA</b>	3 metre aluminium height bar with text and hanger kit
<b>HB4-PA</b>	4 metre aluminium height bar with text and hanger kit
<b>HB5-PA</b>	5 metre aluminium height bar with text and hanger kit
<b>HB6-PA</b>	6 metre aluminium height bar with text and hanger kit
<b>HBS500</b>	Adjustable height bar stand-off bracket (each)
<b>HBPSM1</b>	Surface mount post 89 x 89 x 4mm – 3.2 metres high
<b>HBPBG</b>	In-ground post 89 x 89 x 4mm – 4 metres long
<b>KIT22</b>	Additional hanger kit

<b>Material:</b>	Height bar – 145 x 40 extruded aluminium.
<b>Finish:</b>	Yellow powder coat. Galvanised steel chain.
<b>Length:</b>	2, 3, 4, 5 or 6 metres.
<b>Weight:</b>	2 metre with hangers – 6.4kgs. 3 metre with hangers – 9kgs. 4 metre with hangers – 11.5kgs. 5 metre with hangers – 14.2kgs. 6 metre with hangers – 16.7kgs.



**Stand-off Bracket and hanger kit**



**Surface mount post**

## Engineered Height Bars

Group 2 height bars include those that exceed the height or width dimensions of our Group 1 design. Group 2 height bar structures are engineered 'up to' a maximum height of 8 metres or a width of 12 metres, and as they tend to be site specific and are made to order from stock components. They utilise an extruded aluminium height bar rail while the supporting structure is hot dip galvanised mild steel SHS.

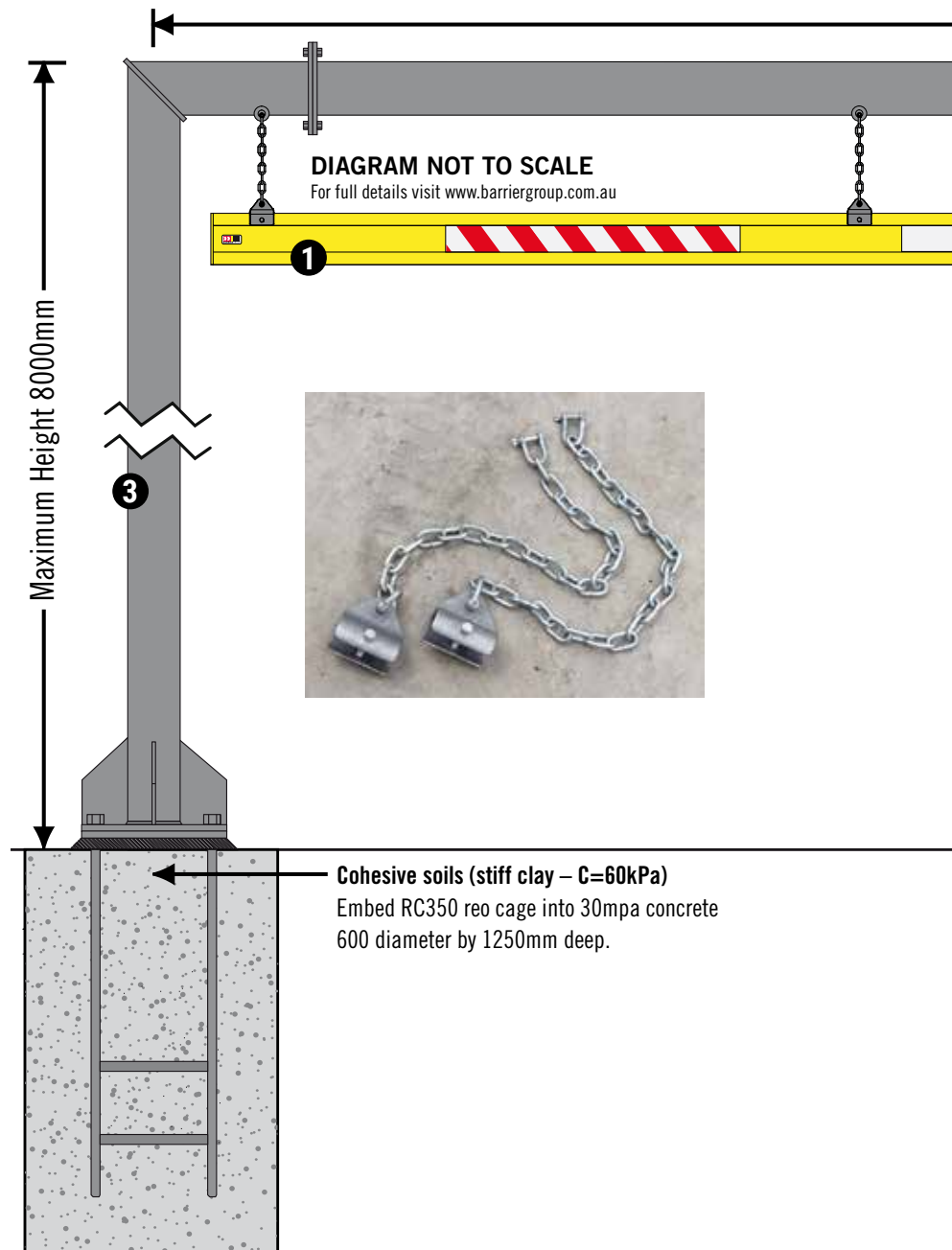

**\*Note:** Diagram not to scale.  
See website for more details.

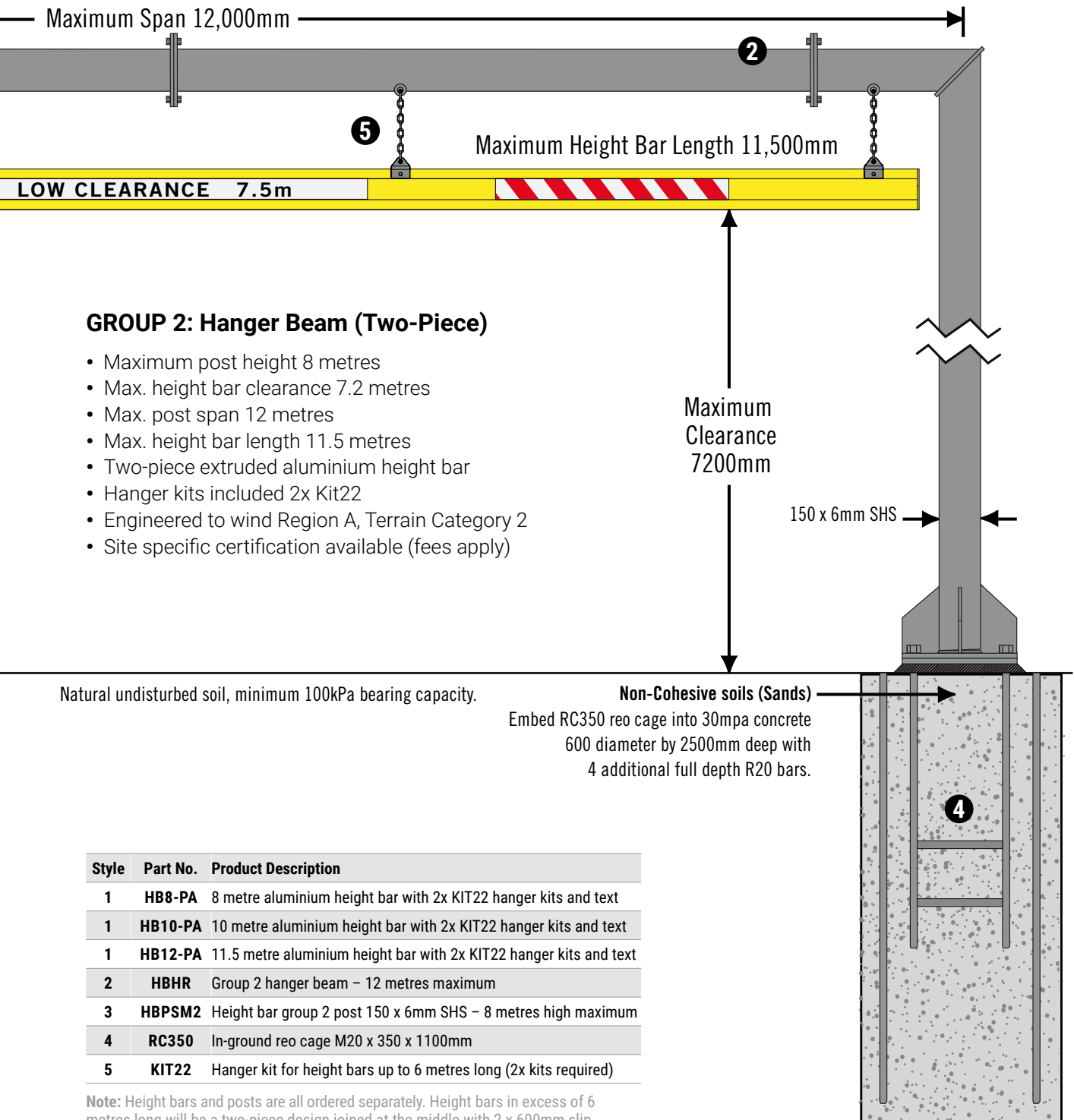

**GROUP 2: Hanger Beam (Two-Piece)**

- Maximum post height 8 metres
- Max. height bar clearance 7.2 metres
- Max. post span 12 metres
- Max. height bar length 11.5 metres
- Two-piece extruded aluminium height bar
- Hanger kits included 2x Kit22
- Engineered to wind Region A, Terrain Category 2
- Site specific certification available (fees apply)

Style	Part No.	Product Description
1	HB8-PA	8 metre aluminium height bar with 2x KIT22 hanger kits and text
1	HB10-PA	10 metre aluminium height bar with 2x KIT22 hanger kits and text
1	HB12-PA	11.5 metre aluminium height bar with 2x KIT22 hanger kits and text
2	HBHR	Group 2 hanger beam – 12 metres maximum
3	HBPSM2	Height bar group 2 post 150 x 6mm SHS – 8 metres high maximum
4	RC350	In-ground reo cage M20 x 350 x 1100mm
5	KIT22	Hanger kit for height bars up to 6 metres long (2x kits required)

**Note:** Height bars and posts are all ordered separately. Height bars in excess of 6 metres long will be a two-piece design joined at the middle with 2 x 600mm slip joiners.